

BESPOKE CLT HOMES

CROSS
LAMINATED
TIMBER

Klopping
TSS
Limited



SIMPLE AND SUSTAINABLE TIMBER PANEL SOLUTIONS

IDEAL FOR MODERN, ECO-FRIENDLY HOMES

*Pre-fabricated full-size
timber panels.*

*Completely bespoke, and
precision engineered.*

*Low carbon construction
material.*

Quick and easy assembly.

*Outstanding price to
performance ratio.*

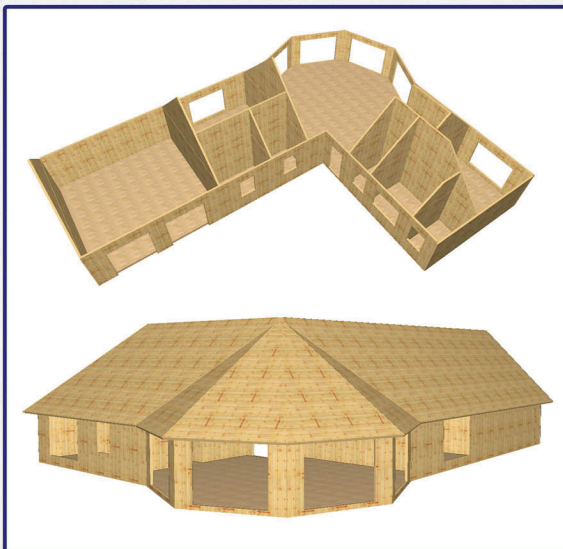

*FROM DELIVERY TO ASSEMBLED
CLT SHELL IN AS LITTLE AS 3 DAYS!*

WHAT IS CROSS LAMINATED TIMBER?

Cross Laminated Timber (CLT) is a modern, ecologically sustainable timber panel system. Each wall, floor and roof panel is a dimensionally stable component, saving valuable time and money on site.

CLT is a strong, durable, light and highly adaptable material.

Carbon from the atmosphere makes up roughly 50% of the mass of our CLT panels. For each cubic metre of timber, CLT locks away up to 900kg of CO₂, reducing the overall carbon footprint of your build.



EXCEPTIONAL QUALITY

CLT panels are pre-fabricated from 3, 5 or 7 cross directional layers of kiln dried spruce, laminated using PUR glue.

Each of our panels is CNC machined to a maximum size of 13000 x 3200 x 200mm.

Cut outs for doors, windows, cables, sockets and pipes are all pre-cut to meet with the design requirements of each order.



A THING OF BEAUTY

As well as raw, non-visible and visible finishes, we also offer luxury hardwood, metal or concrete effect finishes for interior surfaces.

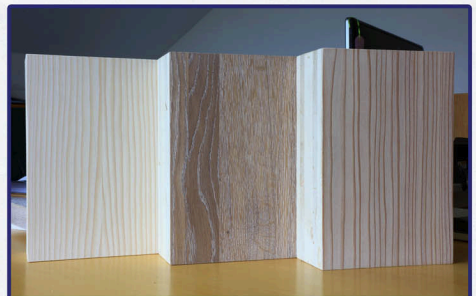

COMFORT & LIFESTYLE

CLT panels are naturally airtight but breathable. The CLT diffuses moisture to and from the surrounding air.

This helps to balance indoor humidity levels and maintain a comfortable interior climate throughout the year.

Since CLT is breathable. It is recommended that breathable insulation and finishes are used, such as wood fibre insulation and fibre boards.

TECHNICAL DATA

Wood Moisture Content	12% \pm 2%
Weight	450 - 500 kg/m ³
Water Vapour Transmission	40-70 μ
Thermal Conductivity	0.12 W/mK.
Specific Heat Capacity	1600 J/kgK

U-value of 0.18 W/m²K and fire resistance REI 90 can be achieved using an approx. 300mm wall with...

- 100mm 3-layer CLT panel
- Suitable breathable insulation
- External render finish
- Internal plasterboard



HOW IT WORKS

A CLT frame for a typical detached house can take as little as 3 to 4 days to erect...

DAY 0 - Preparation Work

- Check raft dimensions and set out wall positions.
- Roll out bitumen DPC under walls.
- Fix mounting brackets.

DAY 1

- Level out with shims and expanding mortar.
- Crane wall panels into position in sequence, apply sealing tape and secure.
- Crane floor slabs into position in sequence, connect length joints, apply sealing tape and secure.

DAY 2

- Set out upper wall positions and fix mounting brackets.
- Crane wall panels into position in sequence, apply sealing tape and secure.

DAY 3

- Fit roof structure in sequence.
- Apply sealing tape for airtightness.
- Start external roof insulation.
- Start external wall insulation.
- Begin fitting windows and doors.

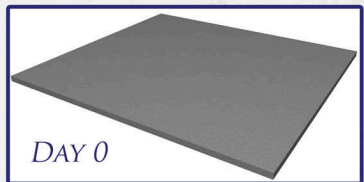

DAY 0

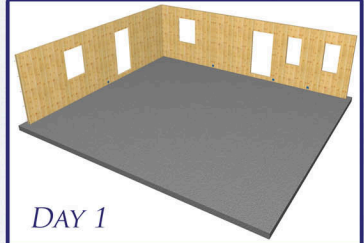

DAY 1



DAY 1



DAY 2



DAY 3-4

CONTACT US WITH YOUR ENQUIRY TODAY!